



World Health
Organization

SHIPPERS' PROGRAMME 2015-2016



Module 4

Marking and Labelling Packages of Infectious Substances



World Health
Organization

Overview

- ⚠ Improper markings and labels
- ⚠ Package markings and labels
- ⚠ Marking and labelling Category A packages
- ⚠ Marking and labelling Category B packages
- ⚠ Marking and labelling Exempt Human/Animal Specimen packages
- ⚠ Package marking and labelling exercise



World Health
Organization

**What happens if a package is marked or
labelled improperly?**



World Health
Organization

Improper marking and labelling

- ⚠ Package **should not** be accepted (by carrier)
- ⚠ Courier refusal
- ⚠ Package may be returned to shipper
- ⚠ Package may be delayed
- ⚠ Package may be destroyed
- ⚠ Customs retention



**World Health
Organization**

Markings and labels



World Health
Organization





Markings and labels

Markings

- Shipper's name and address
- Receiver's name and address
- Name and telephone number of responsible person (who is available 24 hours a day until shipment arrives; emergency contact)
- Proper Shipping Name
- UN Number
- UN Specification marking

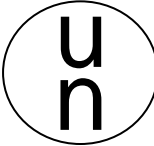
Labels (hazard and handling)

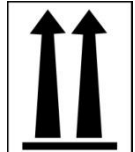
- Infectious substance label
- Orientation arrows (black or red; mandatory, on opposite sides, only when primary containers exceed 50 ml)
- Cargo Aircraft Only (when the package may only be transported on a cargo aircraft)

MARKINGS		
SHIPPER PETER PAN TIMELY LOGISTICS BP 102 I-0956666 NOLAND	RECEIVER AB NORMAL FRANKENSTONE LAB RUE DE L'ESSAI F-9867 ADIEU	
EMERGENCY CONTACT 24H/24H Dr RED PEPPER: +67 56 45 34 23		
	4G/CLASS 6.2/02 F/BVT 312103	
OVERPACK	INFECTIOUS SUBSTANCE, AFFECTING HUMANS UN 2814	
	BIOLOGICAL SUBSTANCE, CATEGORY B EXEMPT HUMAN SPECIMEN	
LABELS		
		



World Health
Organization

Marking and labelling Category A packages



World Health
Organization

Category A markings and labels

Markings

- Shipper's name and address
- Receiver's name and address
- Name and telephone of responsible person (who is available 24 hours a day until shipment arrives)
- Proper Shipping Name
- UN Number
- UN Specification marking

Labels (hazard and handling)

- Infectious substance label
- Orientation arrows (mandatory only when primary container exceeds 50ml)
- Cargo Aircraft Only (when the package may only be transported on a cargo aircraft)





World Health
Organization

Category A markings and labels

Shipper's and Receiver's
Name and Address

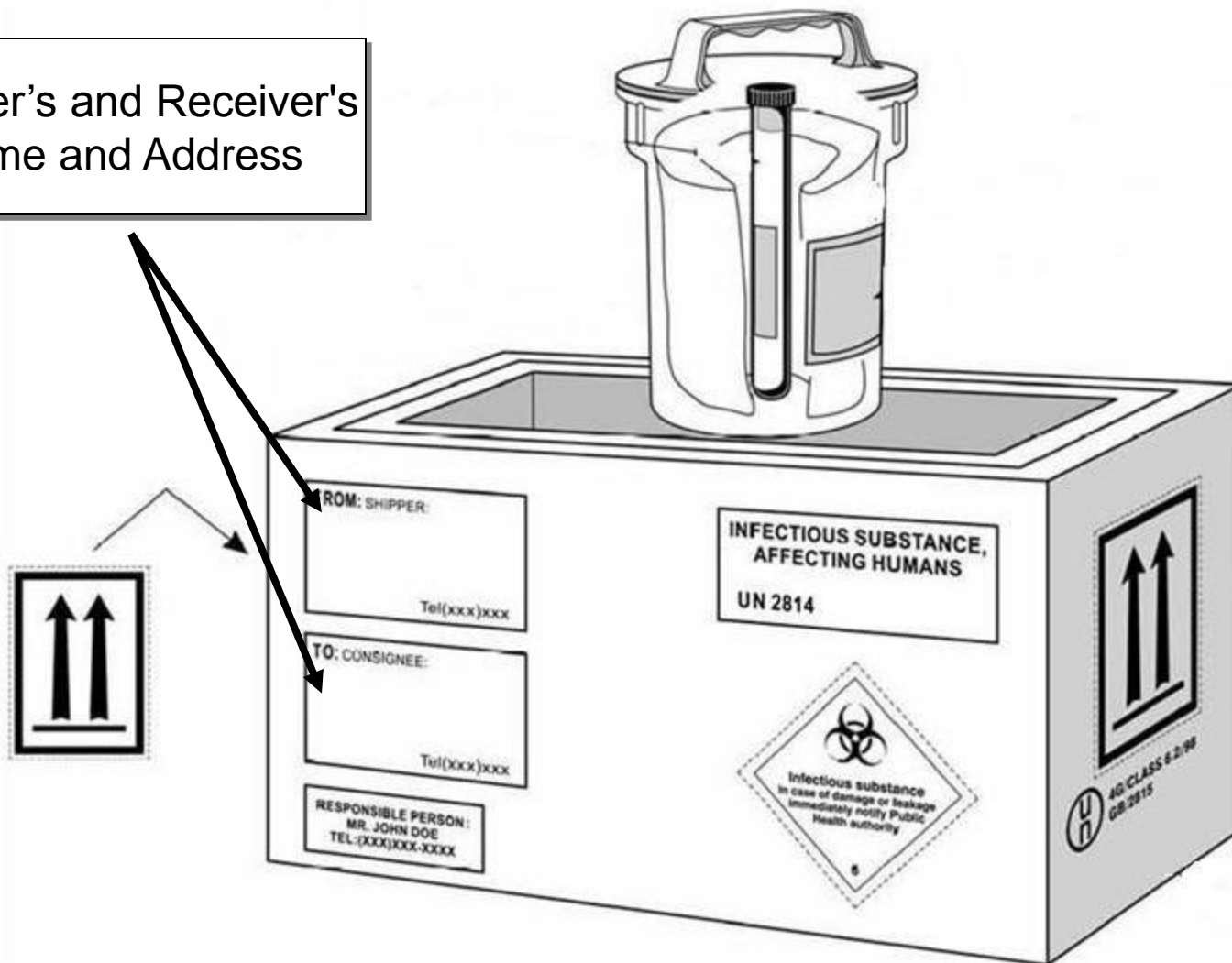



World Health
Organization

Category A markings and labels

Name and Tel. of
Responsible Person

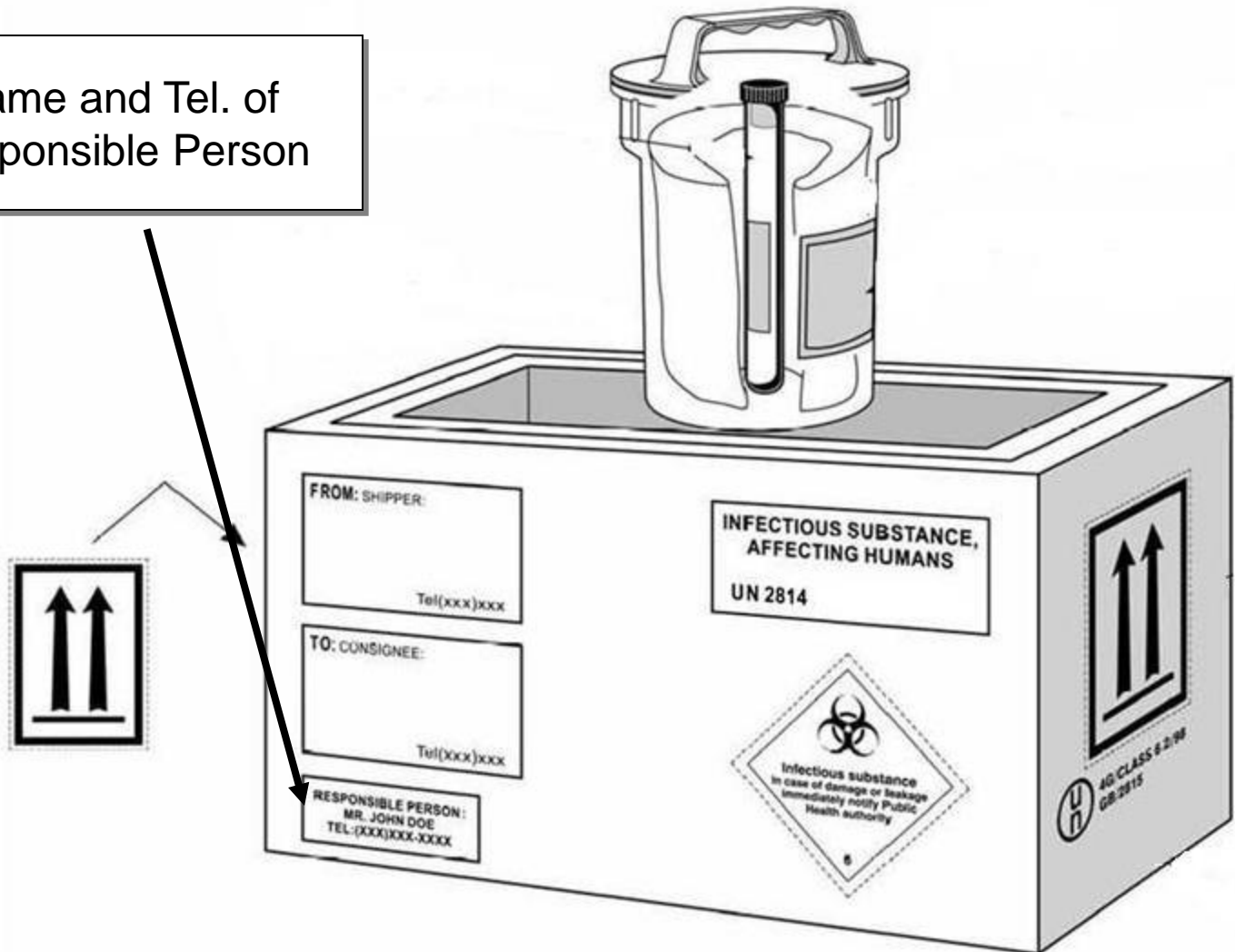



World Health
Organization

Category A markings and labels

Proper Shipping Name
and UN Number

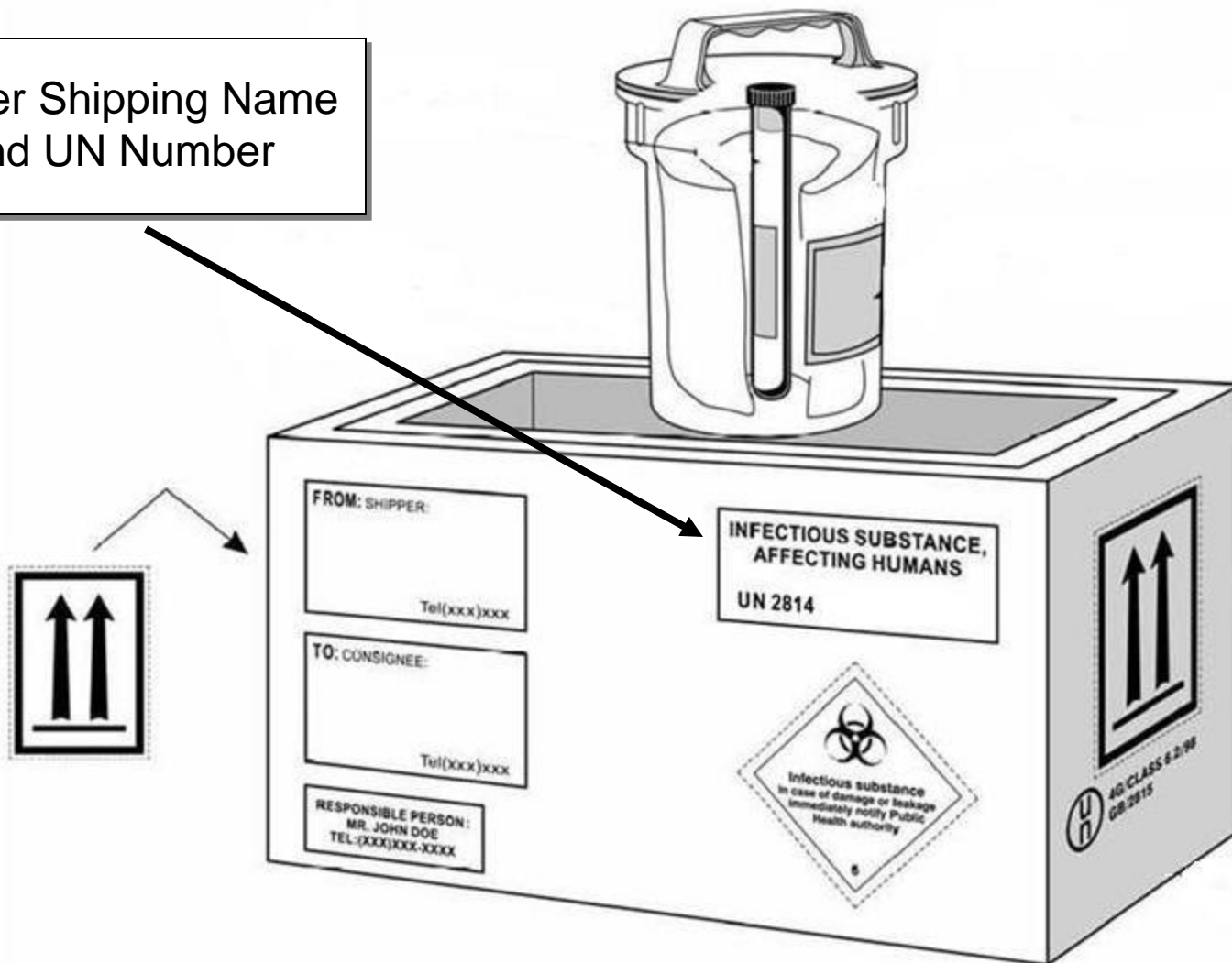



World Health
Organization

Category A markings and labels

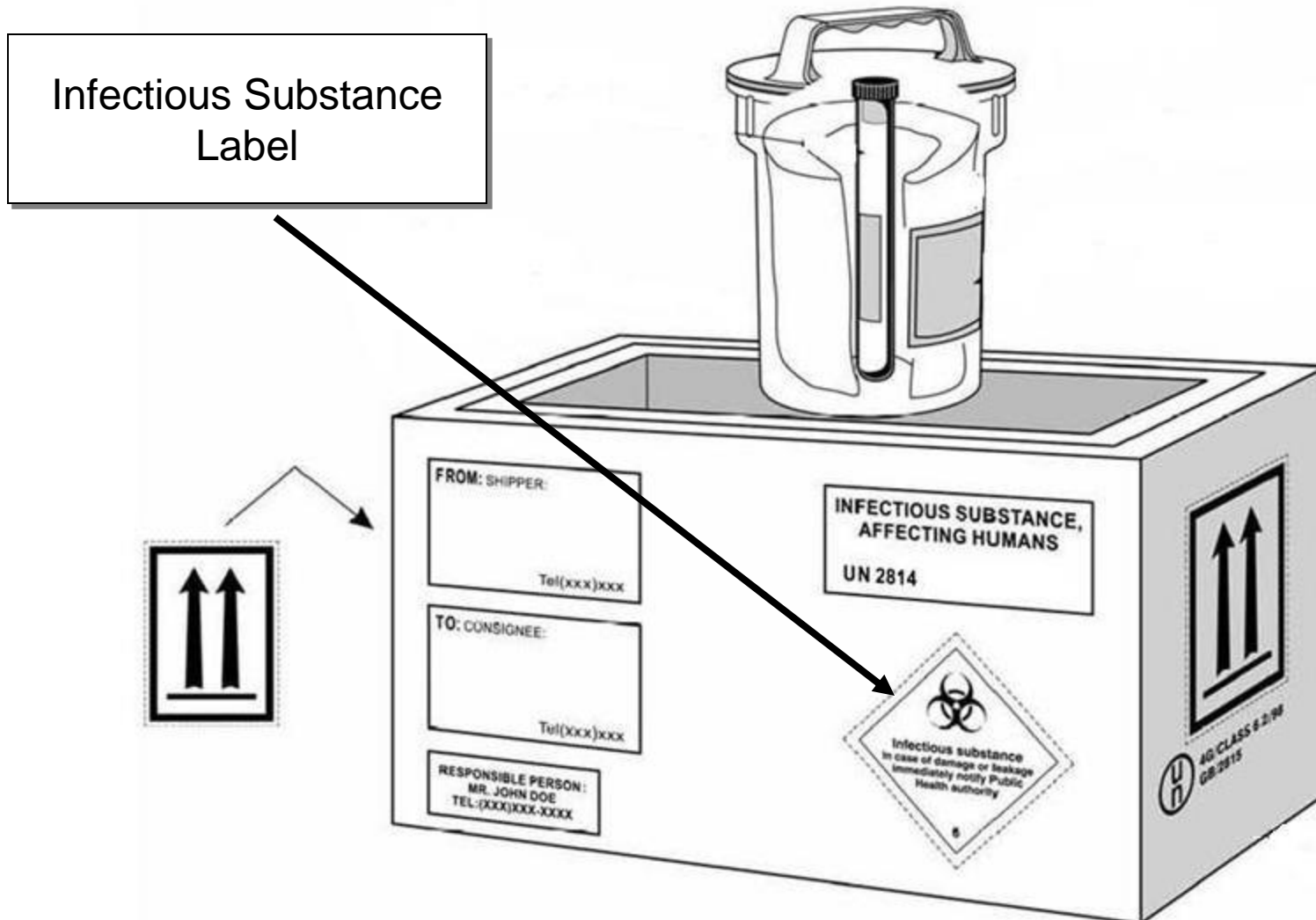



World Health
Organization

Category A markings and labels

Orientation arrows

Mandatory on opposite sides when
total volume of infectious
substance exceeds 50 ml

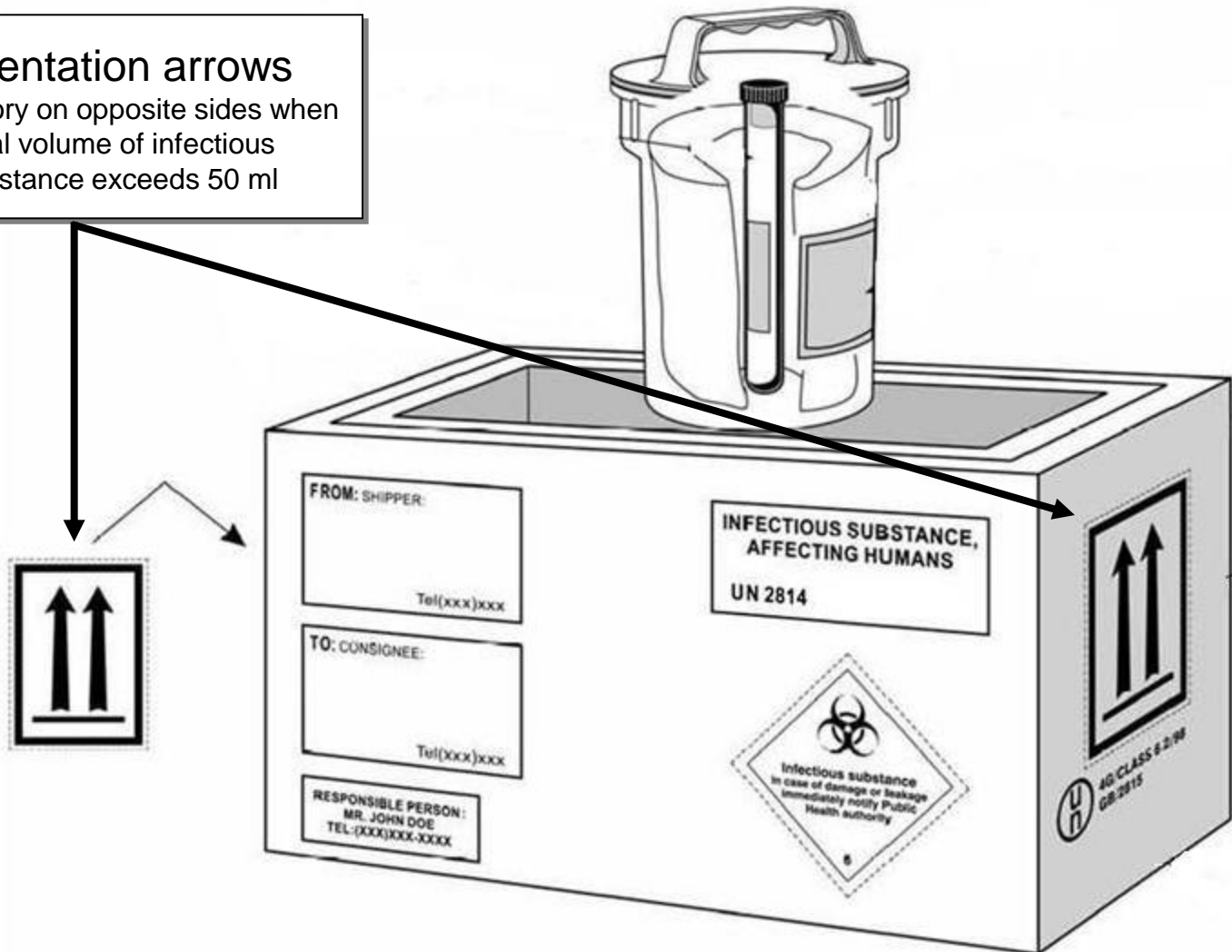



World Health
Organization

Category A markings and labels

Cargo Aircraft Only Label

Mandatory when the package may only
be transported on a cargo aircraft

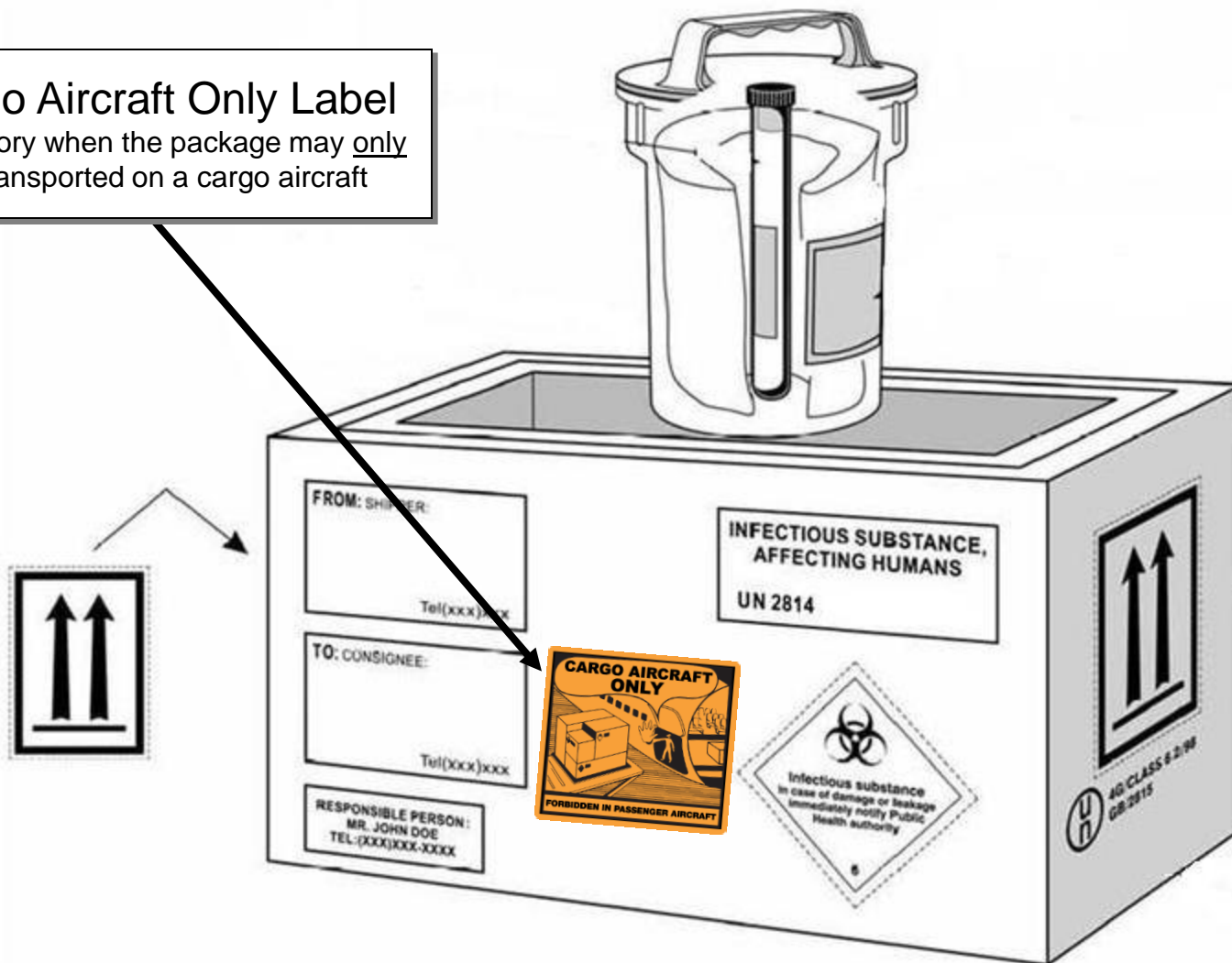



World Health
Organization

Category A markings and labels

UN Specification
marking

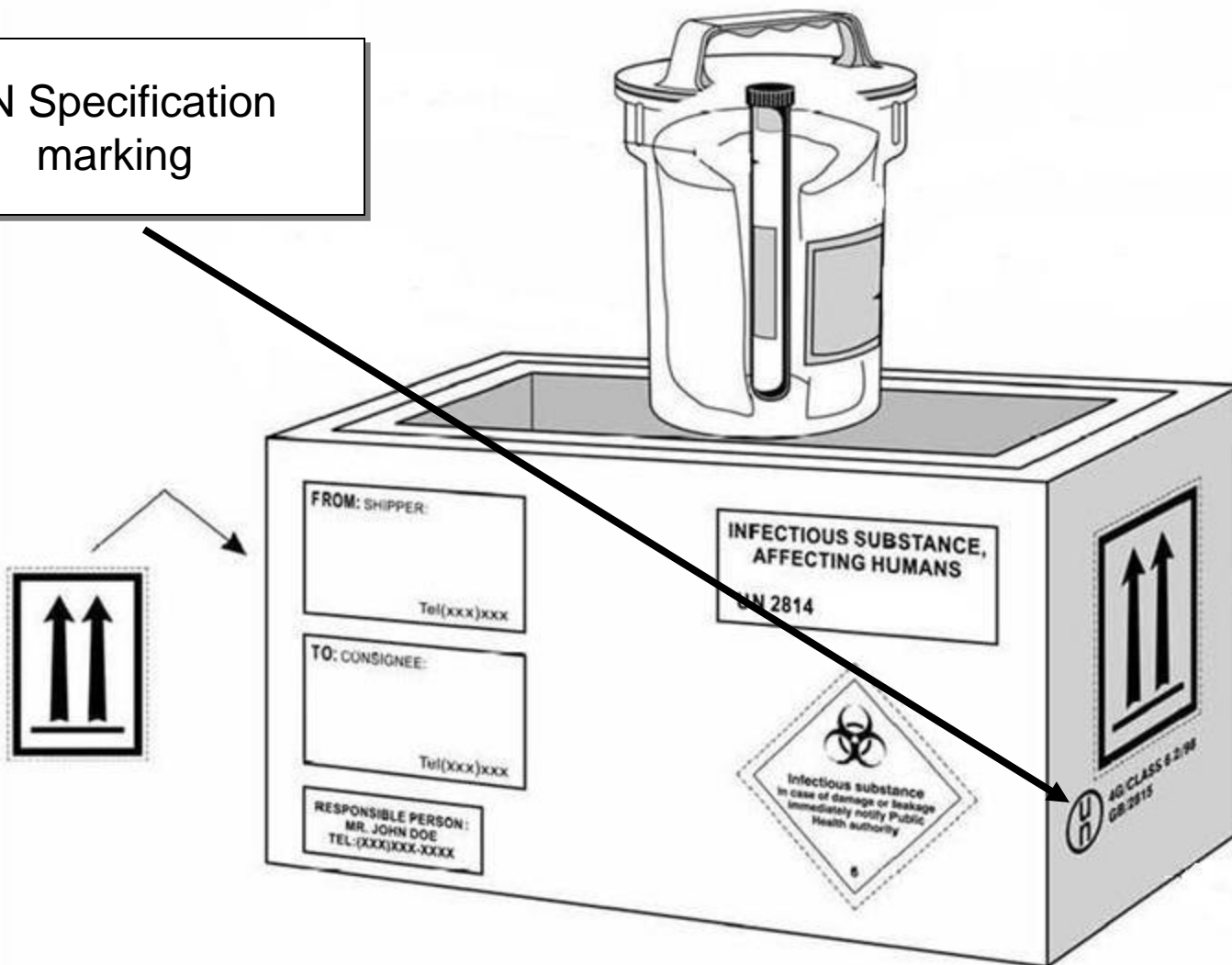



World Health
Organization

Marking and labelling Category B packages



World Health
Organization

Category B markings and labels

Markings

- Shipper's name and address
- Receiver's name and address
- Proper Shipping Name
- UN Number

Labels (hazard and handling)

- None are required (unless shipping with dry ice)





World Health
Organization

Category B markings and labels

Shipper's and Receiver's
Name and Address

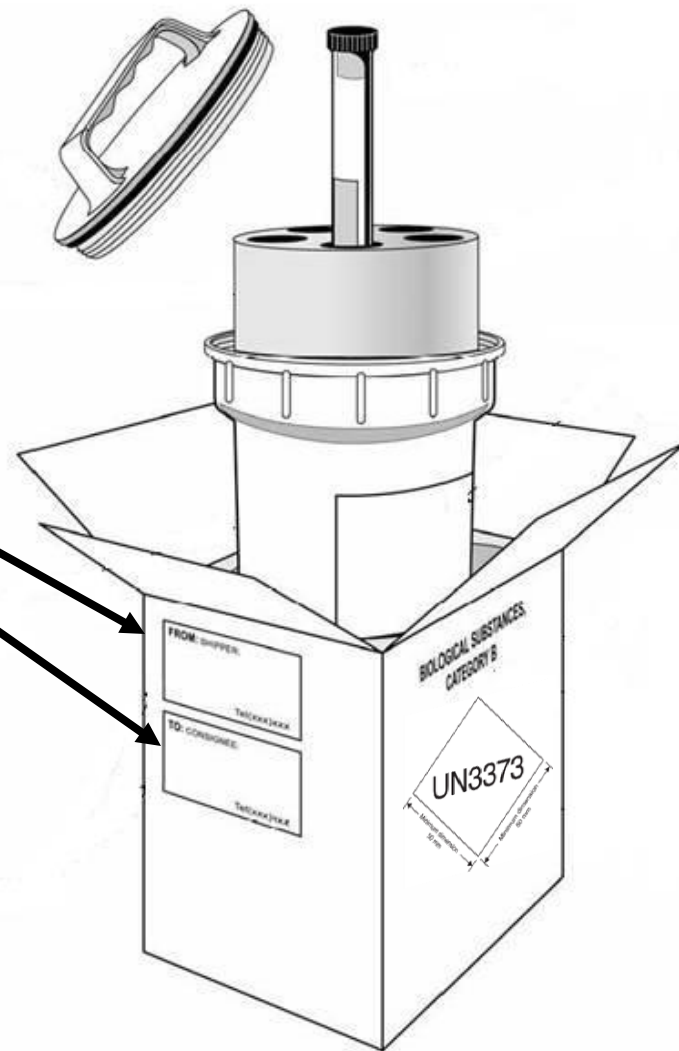



World Health
Organization

Category B markings and labels

Proper Shipping Name

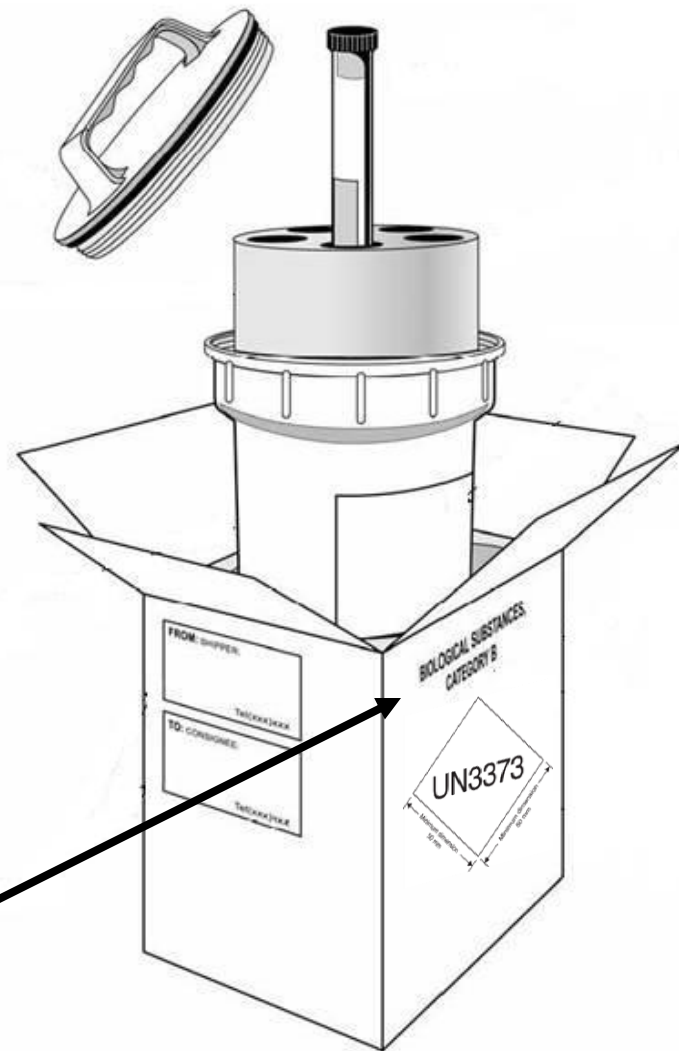



World Health
Organization

Category B markings and labels

UN Number marking

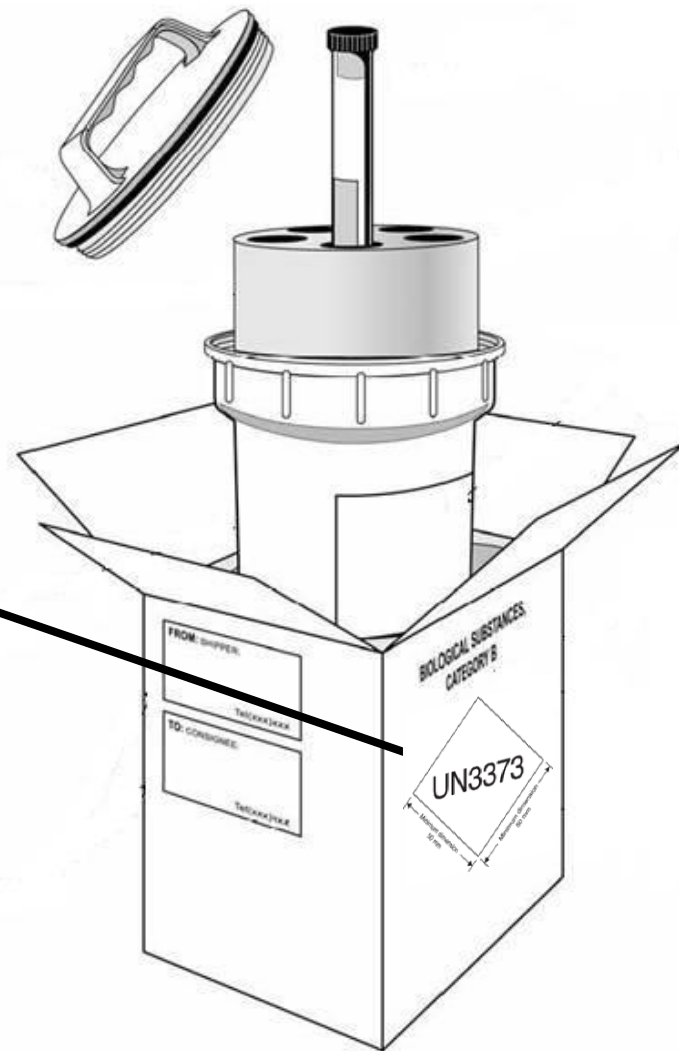



World Health
Organization

Marking and labelling Exempt human/animal specimen packages



World Health
Organization

Exempt human/animal specimens markings and labels

Markings

- Shipper's name and address
- Receiver's name and address
- Proper shipping name

Labels (hazard and handling)

- None are required (unless shipping with dry ice)





World Health
Organization

Exempt human/animal specimens markings and labels

Proper Shipping Name

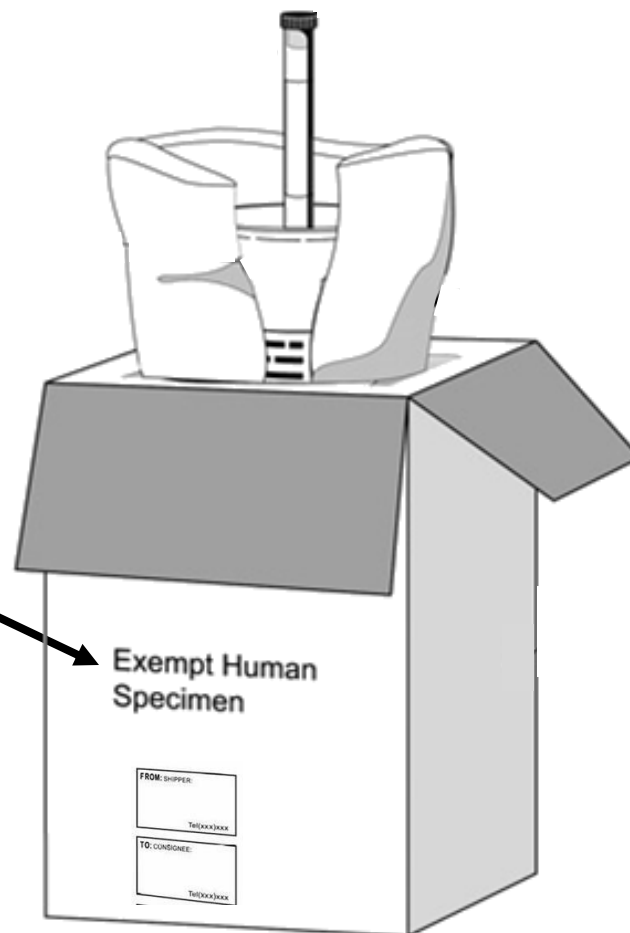
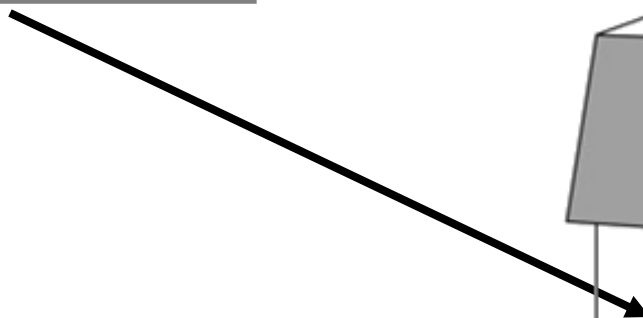



World Health
Organization

Exempt human/animal specimens markings and labels

Shipper's and Receiver's
Name and Address

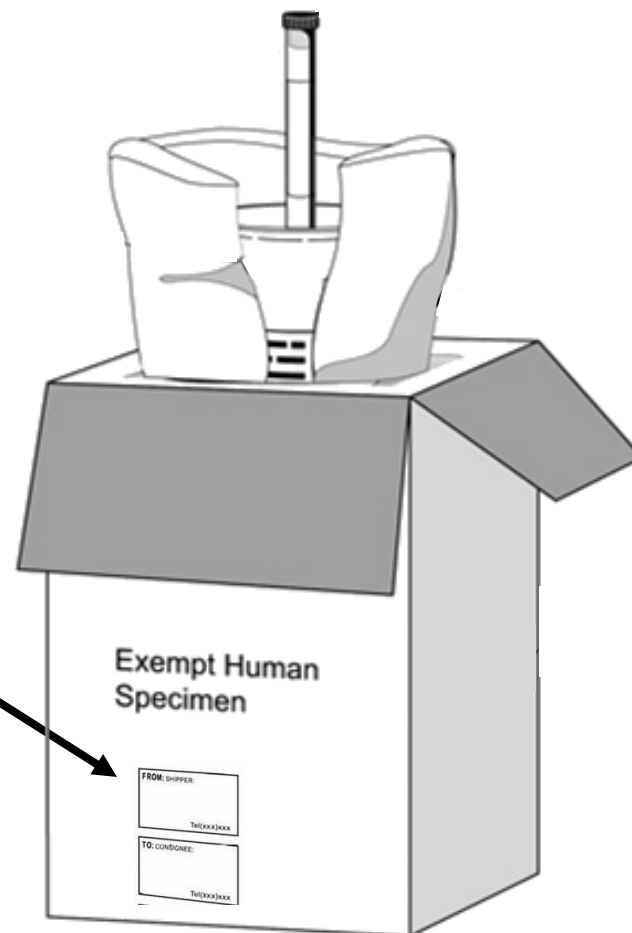



World Health
Organization

Marking and labelling overpacks



World Health
Organization

Overpack markings and labels

- ⚠ Dangerous goods regulations require that each package placed into an overpack be individually marked, labelled and addressed as if each were being shipped independently
- ⚠ Each package must be fully compliant with the regulations before it can be placed in an overpack
- ⚠ Once the package or packages are placed into the overpack, all marks and labels present on the single packages must be reproduced on the overpack, unless they are still visible through e.g. the use of clear shrink-wrap

NOTE: Do not reproduce the UN specification marking on the overpack.

- ⚠ If the overpack includes dry ice, its quantity has to be mentioned on the overpack.
- ⚠ The word "Overpack" must also be marked on the overpack





World Health
Organization

Overpack markings and labels

Markings

- All marks or any other information present on the single packages
- No UN Specification marking on the overpack!
- OVERPACK

Labels (hazard and handling)

- All labels present on the single packages





World Health
Organization

Exercise 4

Marking and labelling packages of infectious substances



World Health
Organization

What is missing?



World Health
Organization

Category A markings and labels

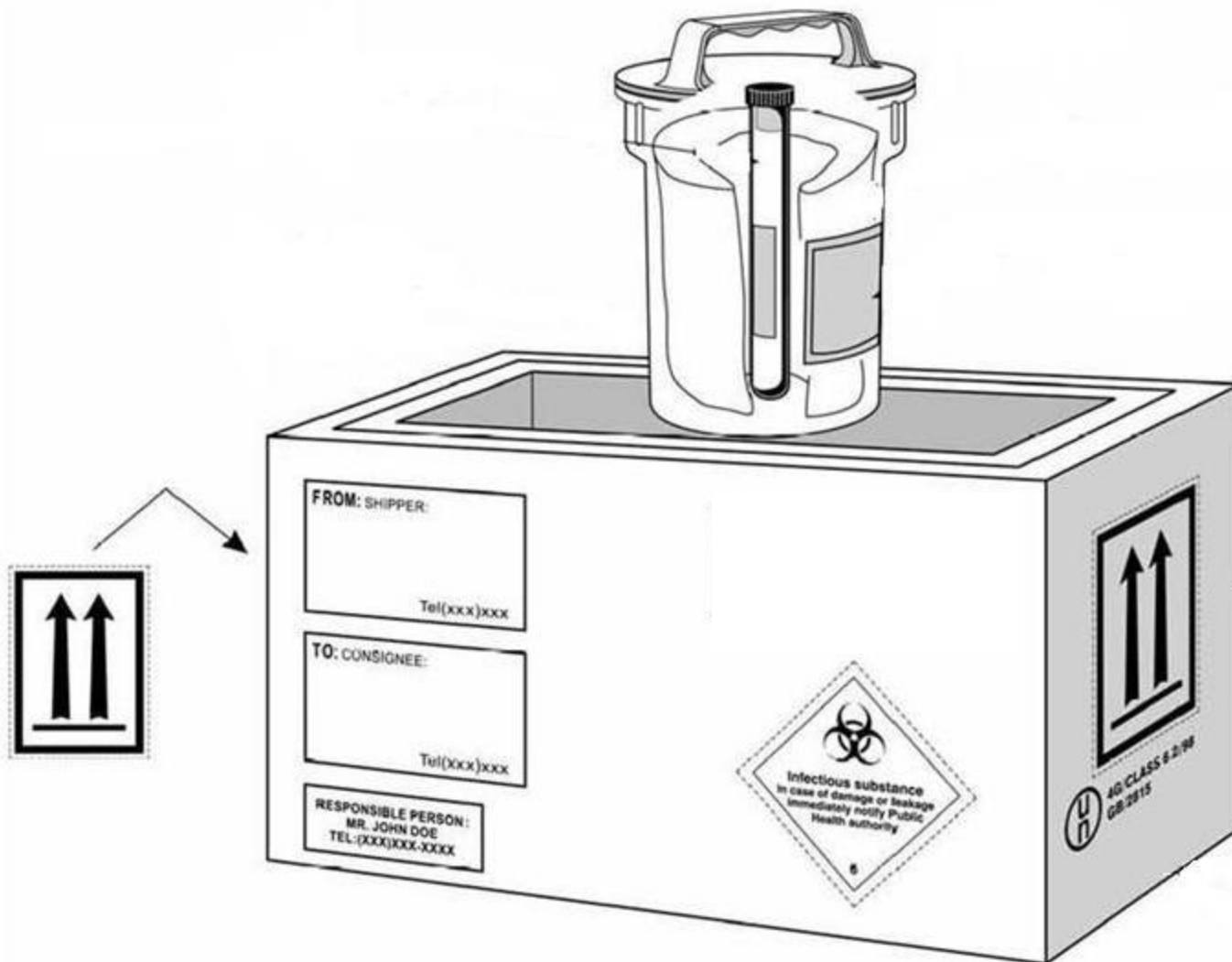



World Health
Organization

Category B markings and labels

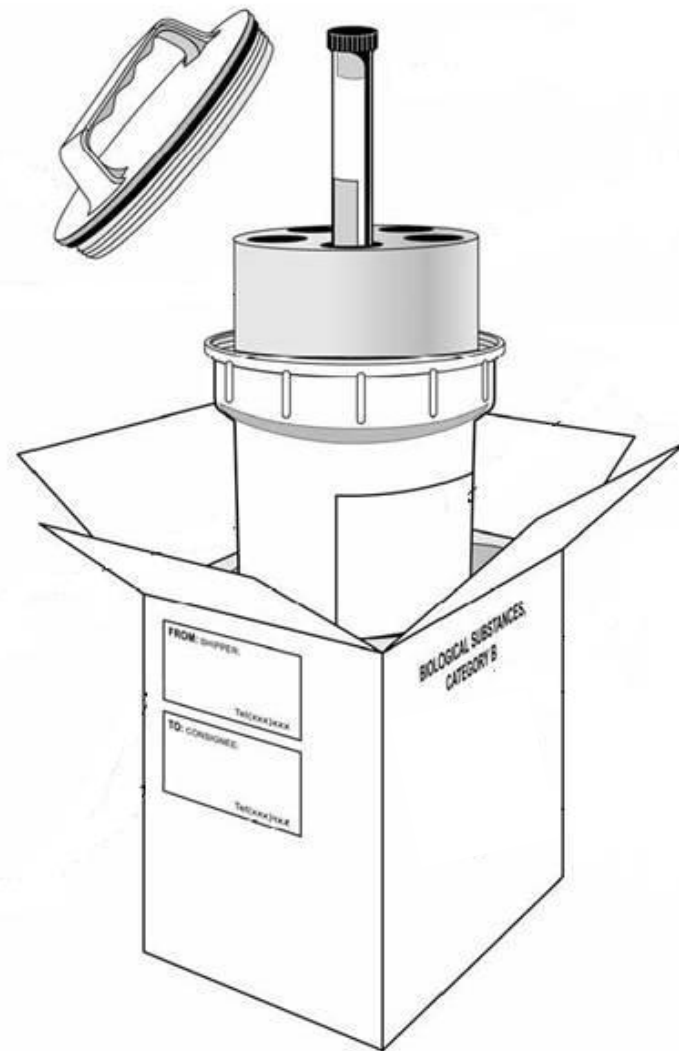



World Health
Organization

Category A markings and labels

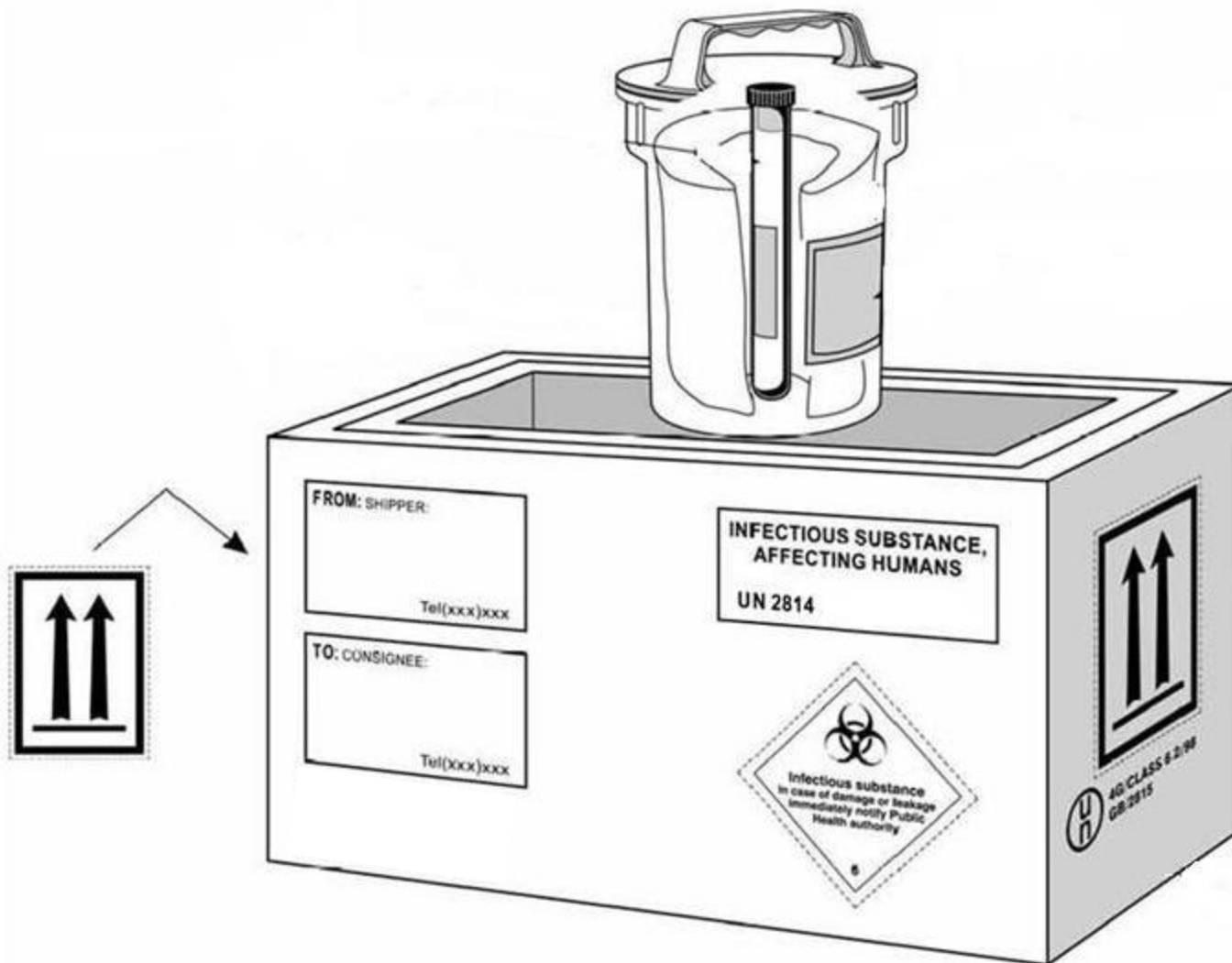



World Health
Organization

Category B markings and labels

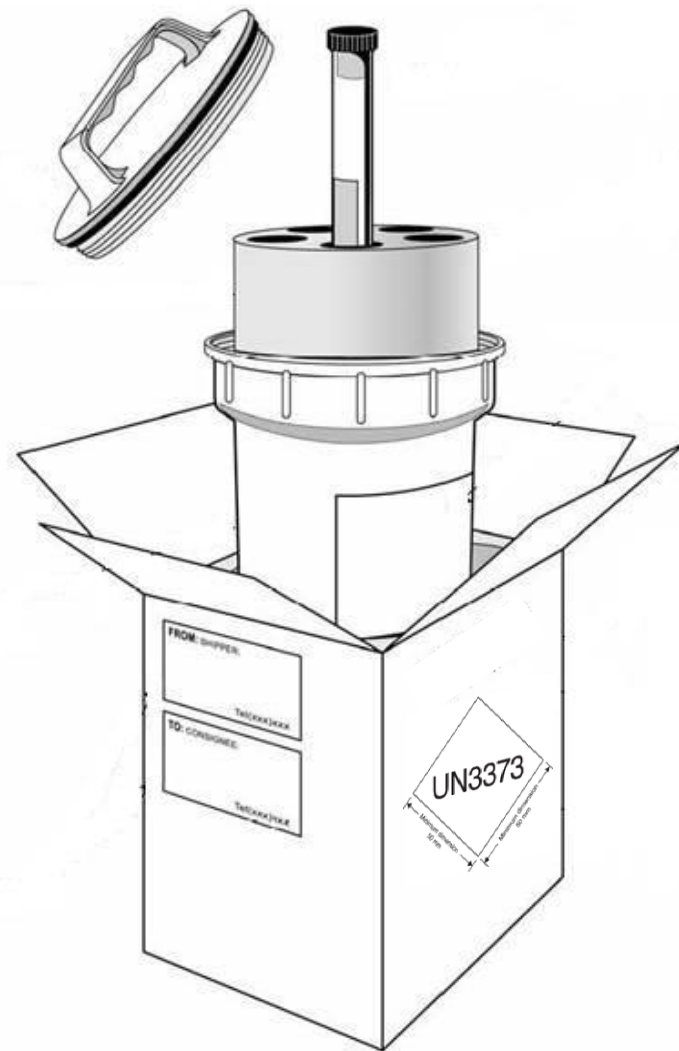



World Health
Organization

Category A markings and labels

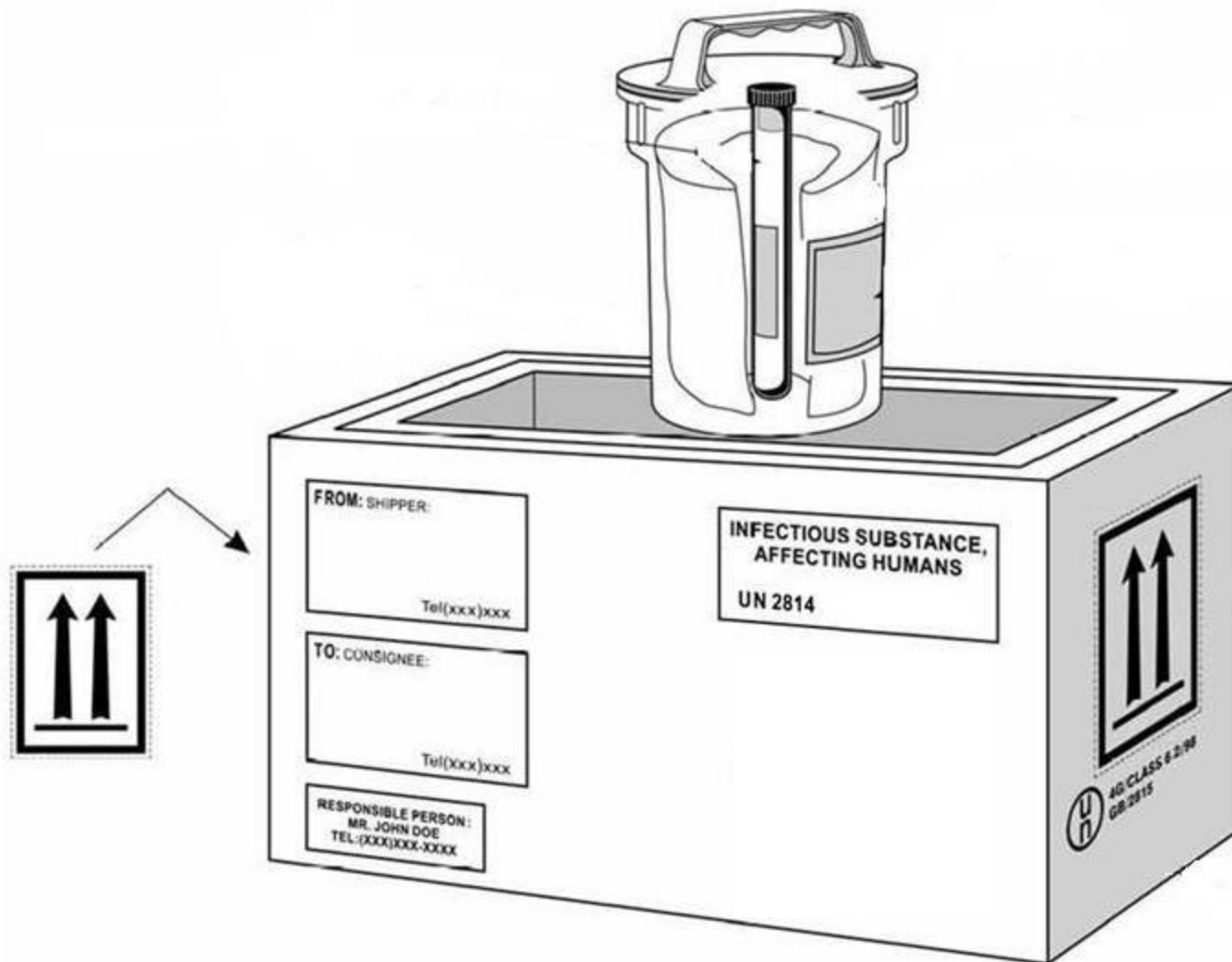



World Health
Organization

Category B markings and labels

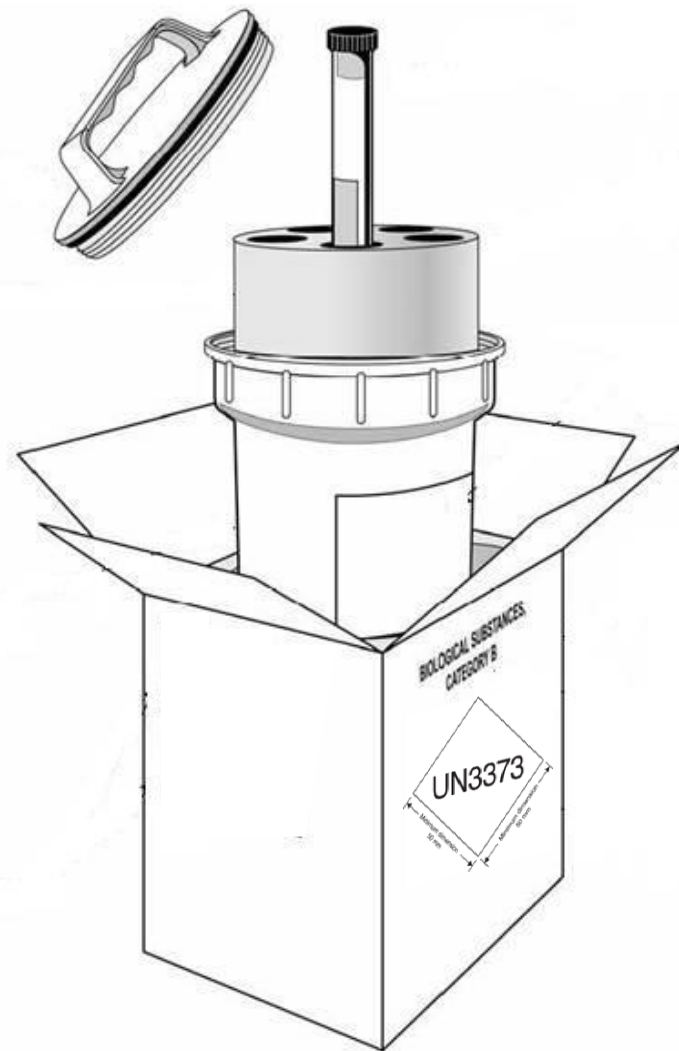



World Health
Organization

Exempt human/animal specimens markings and labels

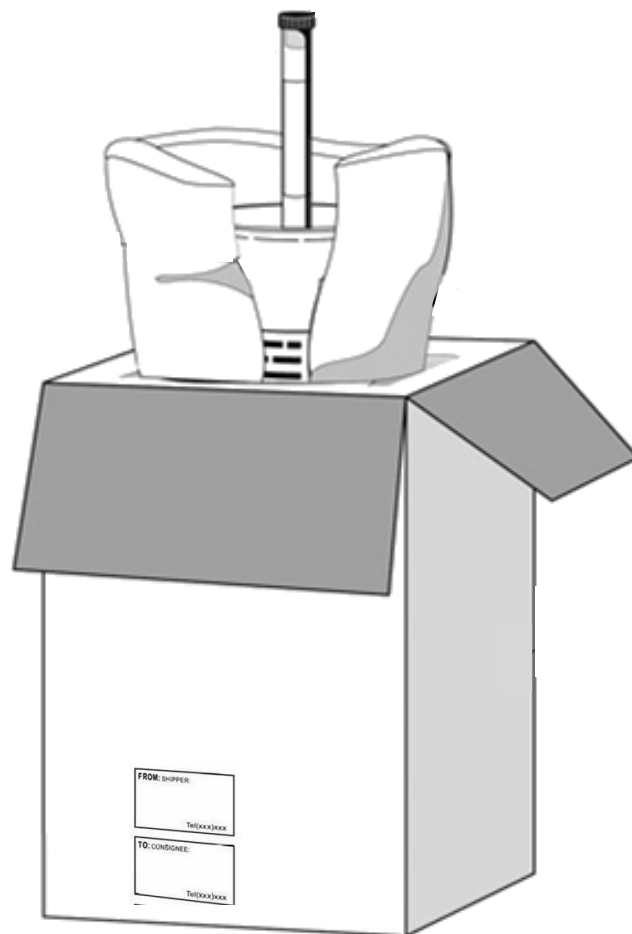



World Health
Organization

Category A markings and labels (>50 ml)

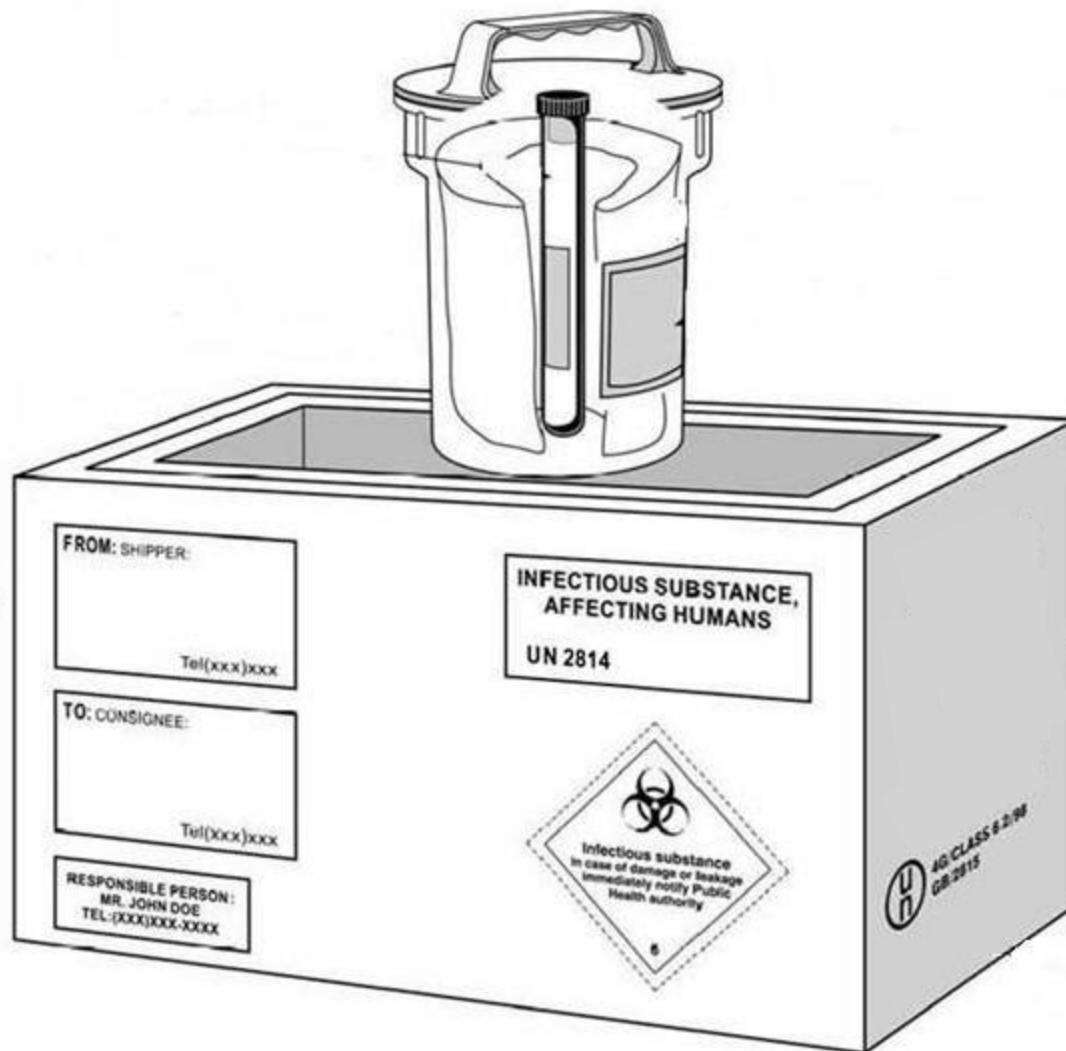



World Health
Organization

Category A markings and labels (>50 ml) for air transport

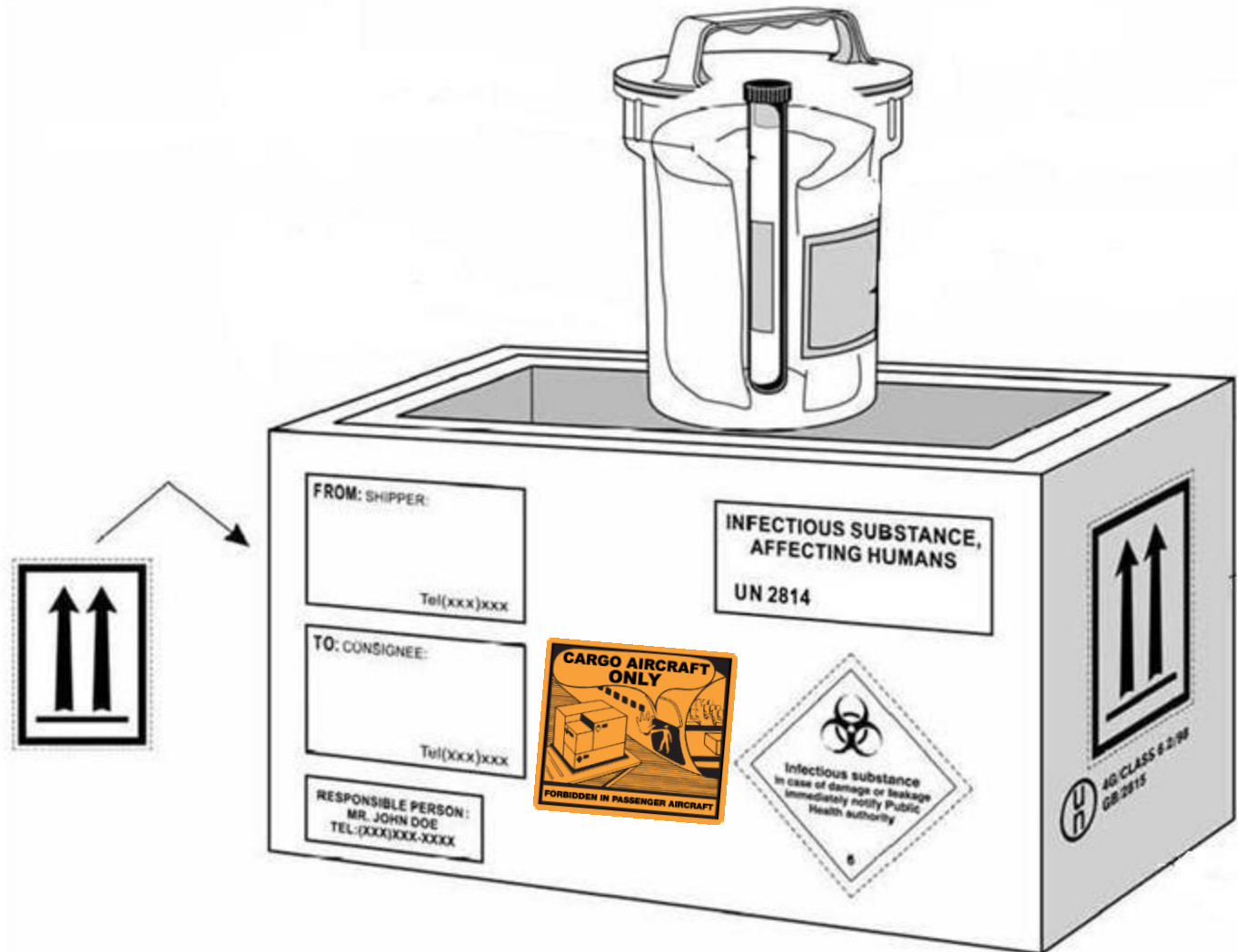



World Health
Organization

Exempt human/animal specimens markings and labels

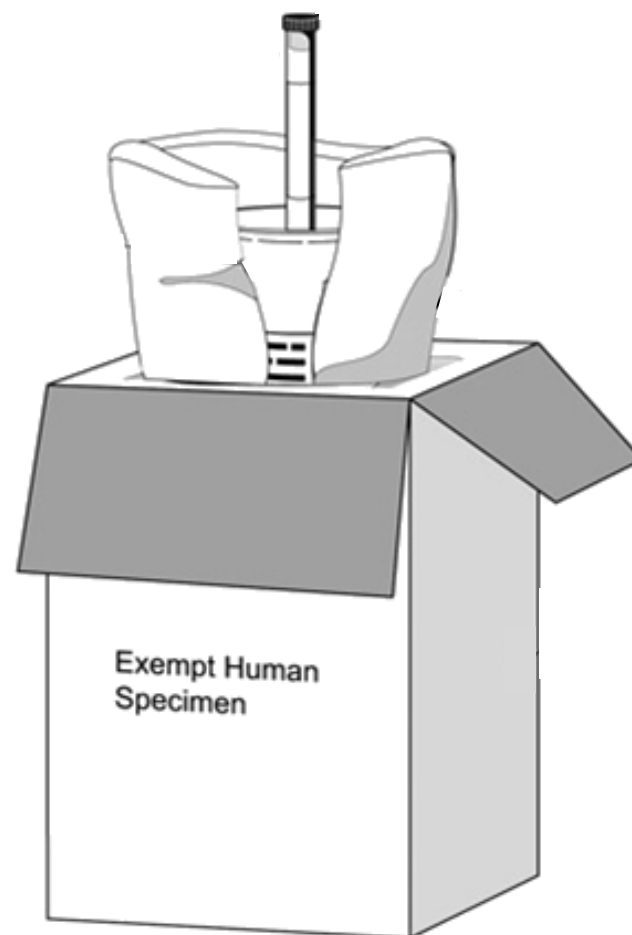



World Health
Organization

Category A markings and labels

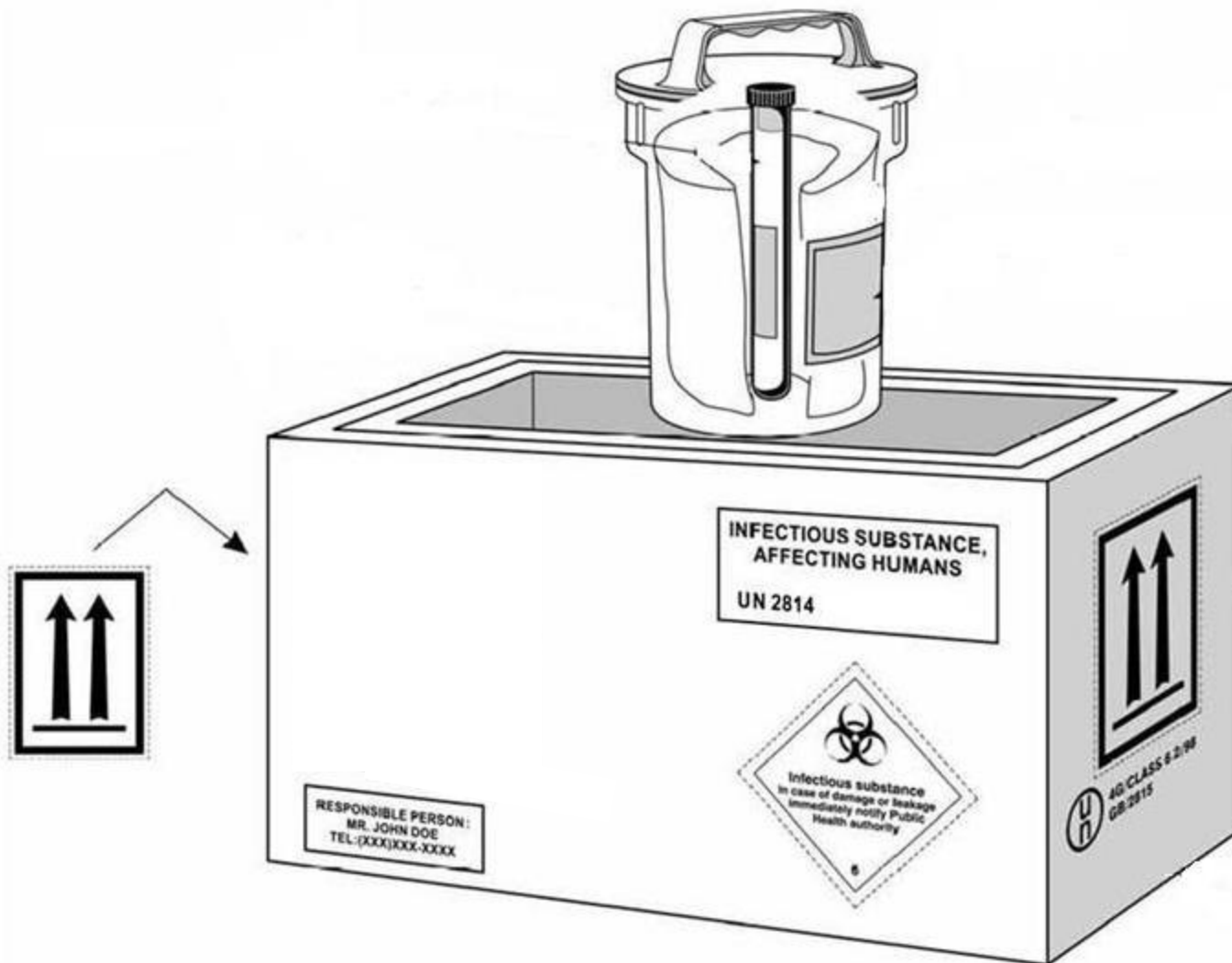



World Health
Organization

Markings and labels for P620

Please list all markings and labels required for this package. Once all the labels and markings have been identified, insert the number where the marking or label would go on the package.

Markings	
1	
2	
3	
4	
5	
6	
Labels	
7	
8	
9	



World Health
Organization

Category A markings and labels

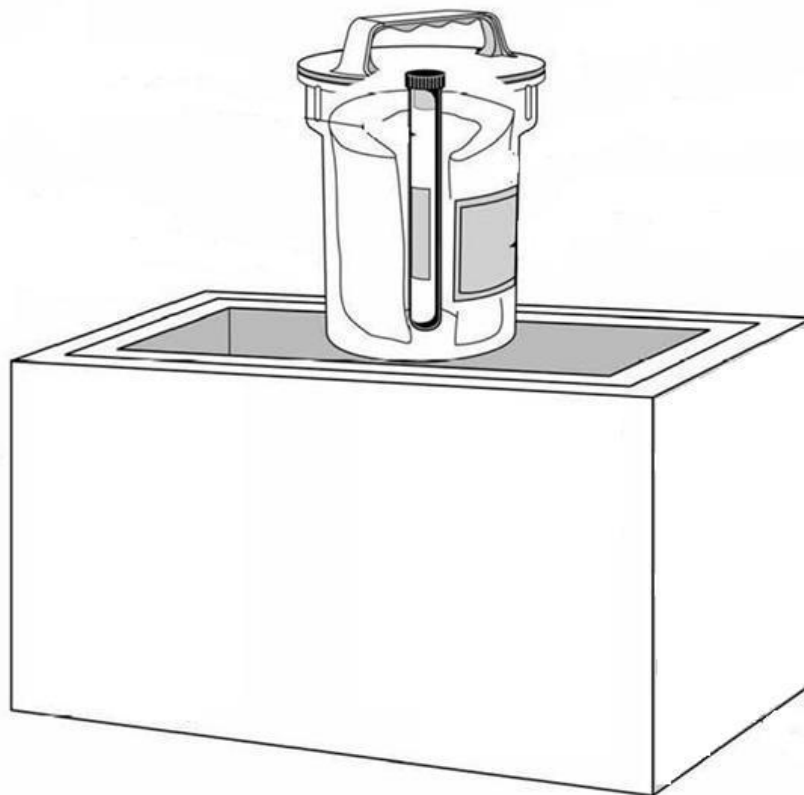



Markings and labels for P650

Please list all markings and labels required for this package. Once all the labels and markings have been identified, insert the number where the marking or label would go on the package.

Markings	
1	
2	
3	
4	
Labels	
-	



**World Health
Organization**

Category B markings and labels

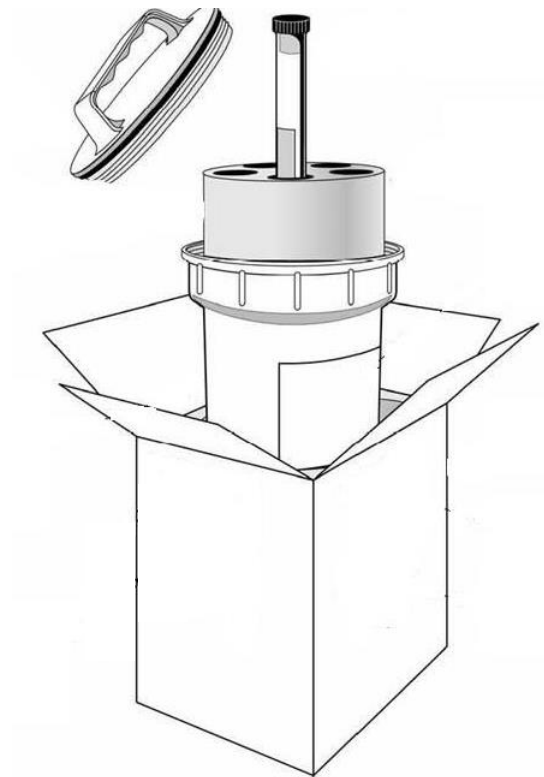



World Health
Organization

Markings and labels for Exempt human/animal specimens

Please list all markings and labels required for this package. Once all the labels and markings have been identified, insert the number where the marking or label would go on the package.

Markings	
1	
2	
3	
Labels	
-	



World Health
Organization

Exempt human/animal specimens markings and labels

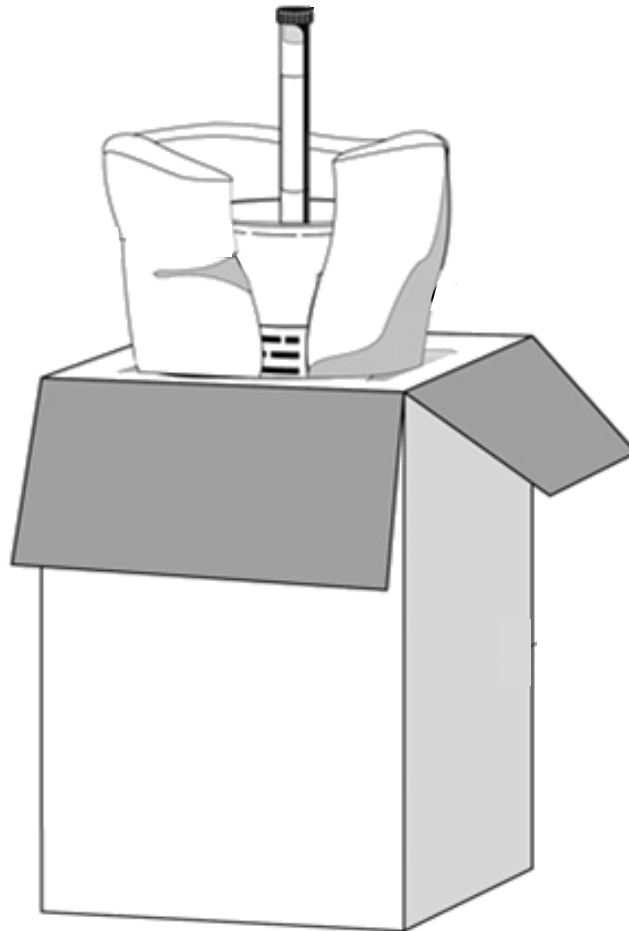



**World Health
Organization**

Questions and comments